

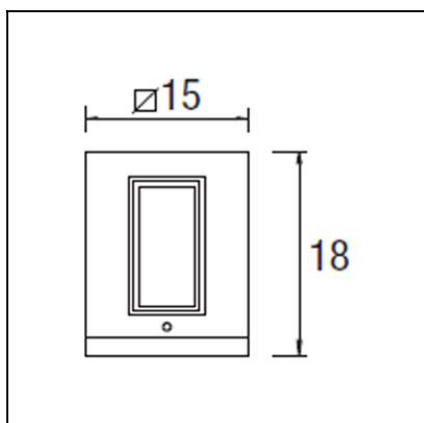

The photograph may not match the reference exactly. Please read the product description to identify the finish.



Download photometric file .ldt /.ies

TECHNICAL CHARACTERISTICS

Type:	Wall fixture
IP Protection degrees:	IP54
IK Protection degrees:	IK06
Lampholder:	1 x R7s
Power (W):	R7s MAX 150W
Bulb included:	1 x R7s 120. Warm White - 3000K
Total power consumption (W):	150
Luminous efficacy (Lm/W):	18.75
CRI:	100
Voltage / Frequency:	230V/50-60Hz
Warranty (Years):	2
Units per box:	4
Net Weight (Kg):	3.26
EAN:	8435111035467,00



MATERIALS / FINISHES

Structure material:	Injected aluminium	Diffuser material:	Glass Glass
Structure finish:	Urban grey	Diffuser finish:	Transparent Lenticular



Luminaria		Ensayo		Lámpara	
Código	05-9159-34-37 A	Código	05-9159-34-37 A	Código	H64696
Nombre	Aplicue FENIX 150W R7s 4 plano	Nombre	Aplicue FENIX 150W R7s 4 plano	Número	1
Familia	- LEDS-C4	Fecha	08-09-2009	Posición	Universal
Eficiencia	21.36%	Sist. de Coord.	C-G	Flujo Total	2200.00 lm
Valor Máximo	185.39 cd	Posición	C=90.00 G=65.00	Bisimétrico	

150mm x 150mm

Semiplanos C

180.0 ————— 0.0
270.0 ————— 90.0

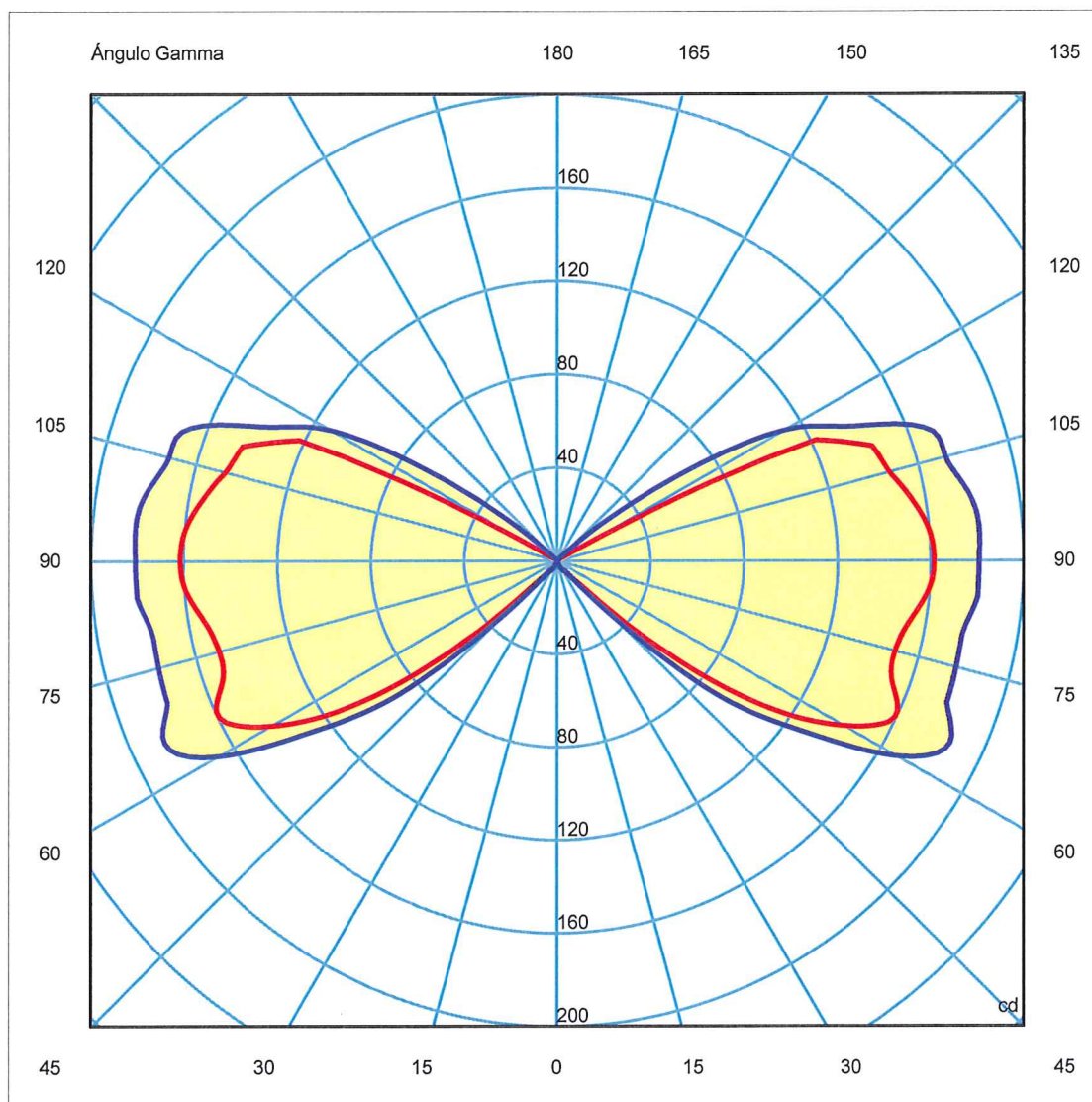
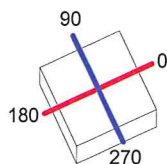

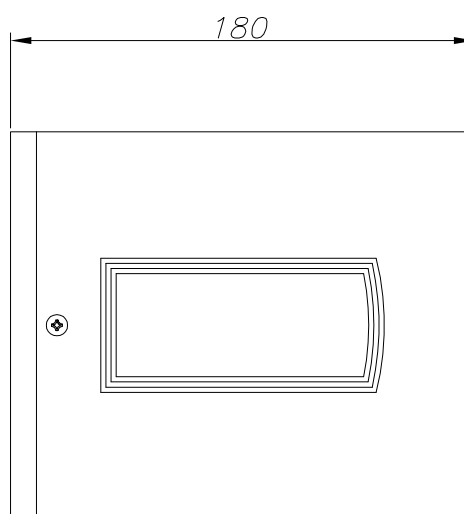
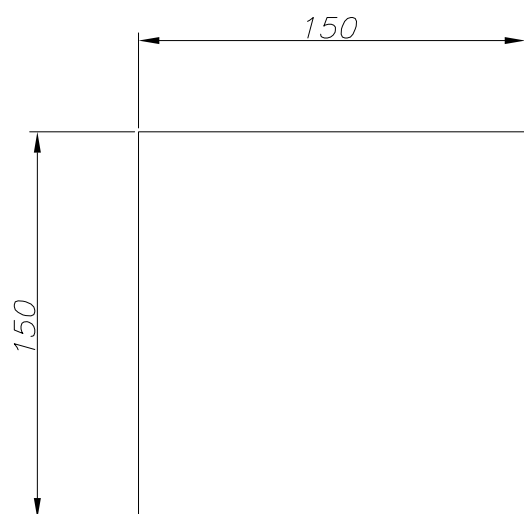

Aluminio inyectado pintado/
Painted injected aluminium

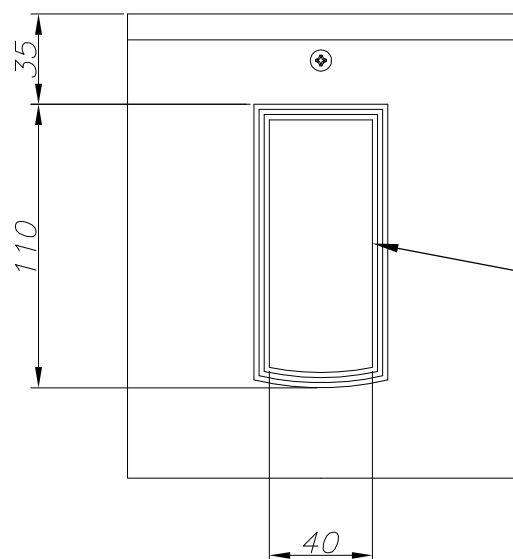

Cristal lupa transparente/
Crystal clear lens

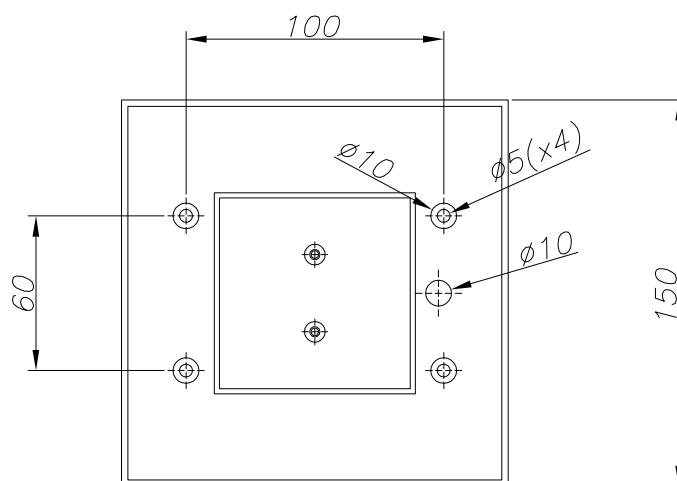

PLANTILLA DE INSTALACIÓN
INSTALLATION TEMPLATE

①

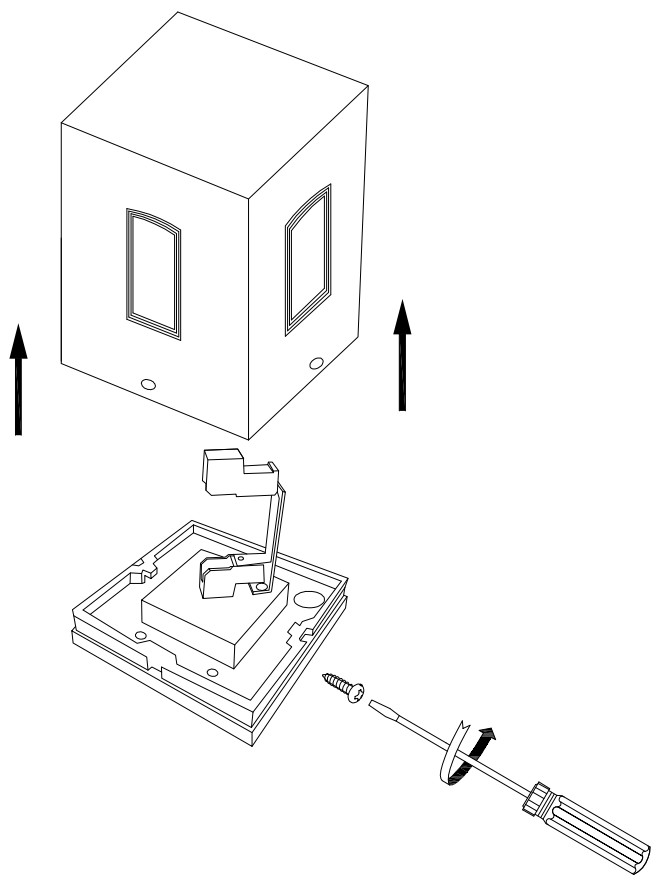

②

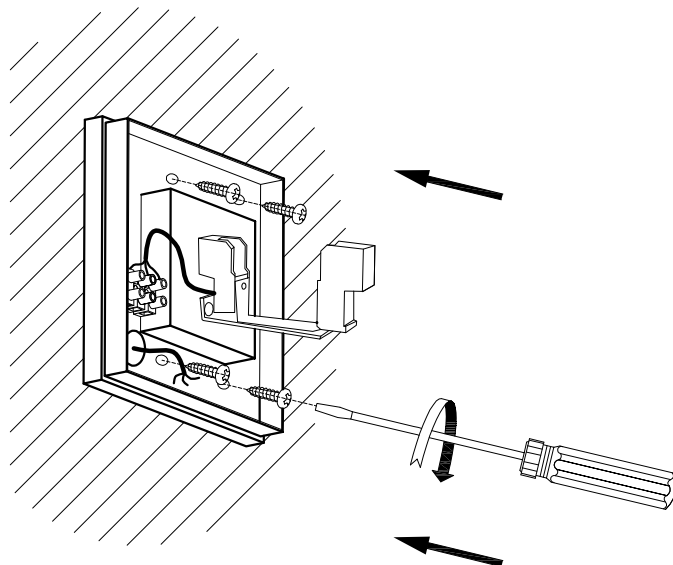

③

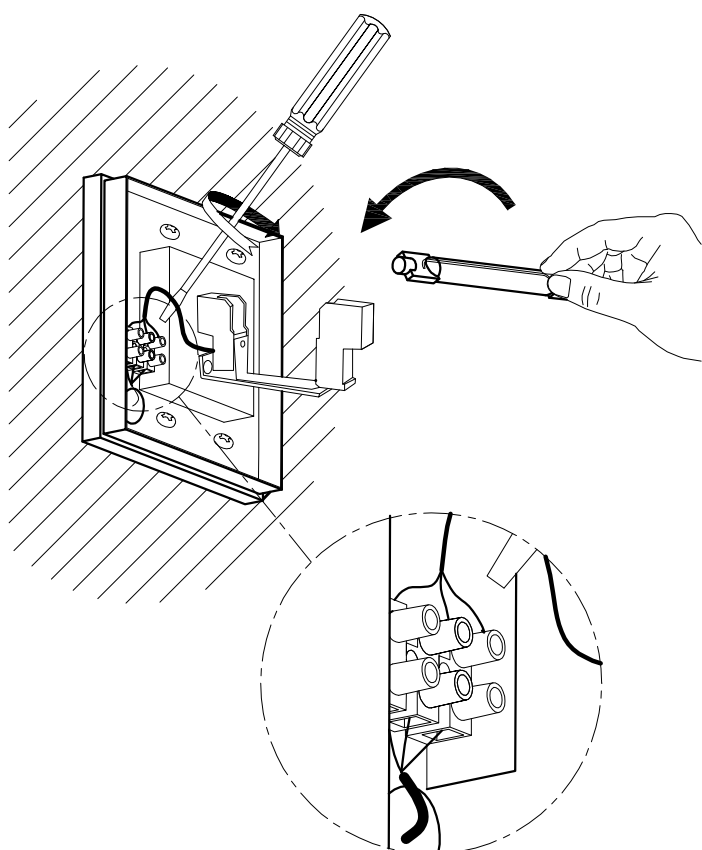

④

