

OUT 

AQUA

55-9697-14-M3



The photograph may not match the reference exactly. Please read the product description to identify the finish.

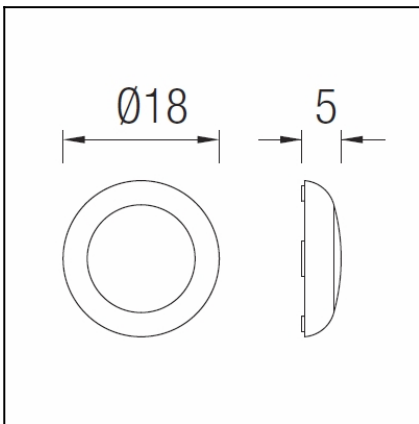

Download photometric file .ldt /.ies

TECHNICAL CHARACTERISTICS

Type:	Wall fixture
IP Protection degrees:	IP68 (2m)
IK Protection degrees:	IK07
Bulb:	3 x LED Cree. Neutral white - 4200K
Power (W):	9
Total power consumption (W):	8
Luminous efficacy (Lm/W):	102
Voltage / Frequency:	12VAC
Warranty (Years):	2
Option to extend the guarantee:	Yes, 5 years
Units per box:	8
Net Weight (Kg):	0.49
EAN:	8435381404536,00

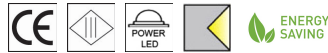

MATERIALS / FINISHES

Structure material: Polycarbonate
Structure finish: White

Diffuser material: Polycarbonate
Diffuser finish: Matt

GEAR

Necessary equipment not included. For more information check website / catalogs / sales organization.

71-9197-05-05



IP68 (1m)

Report No.: 20130307003

Test Time: 2013-3-7 14:52

Luminaire Property

Luminaire Manufacturer: LEDS-C4
 Luminaire Category:
 Lamp Catalog:
 Number of Lamps: 3
 Luminous Length (mm): 100
 Luminous Height (mm): 10
 Current: 0.865 A
 Power Factor: 0.760

Luminaire Description: 55-9697
 Lamp Description: LED
 Lumens per Lamp: 170
 Luminous Width (mm): 100
 Voltage: 12.0 V
 Power: 7.90 W

Photometric Results

CIE Class: Direct
 Measurement Flux: 430.4 lm
 Downward Ratio: 84.40%
 Horizontal Diffuse Angle(10%,50%): H161.6,H108.9
 Vertical Diffuse Angle(10%,50%): V163.4,V110.5
 Luminaire Efficacy Rating (LER): 54
 Max. Intensity: 156.89 cd

Total Rated Lamp Lumens: 510.0 lm
 Efficiency: 84.40%
 Upward Ratio: 0.00%
 Central Intensity: 153.9 cd
 Pos of Max. Intensity: H180 V5

Picture Of Luminaire

Luminous Intensity Distribution Curve

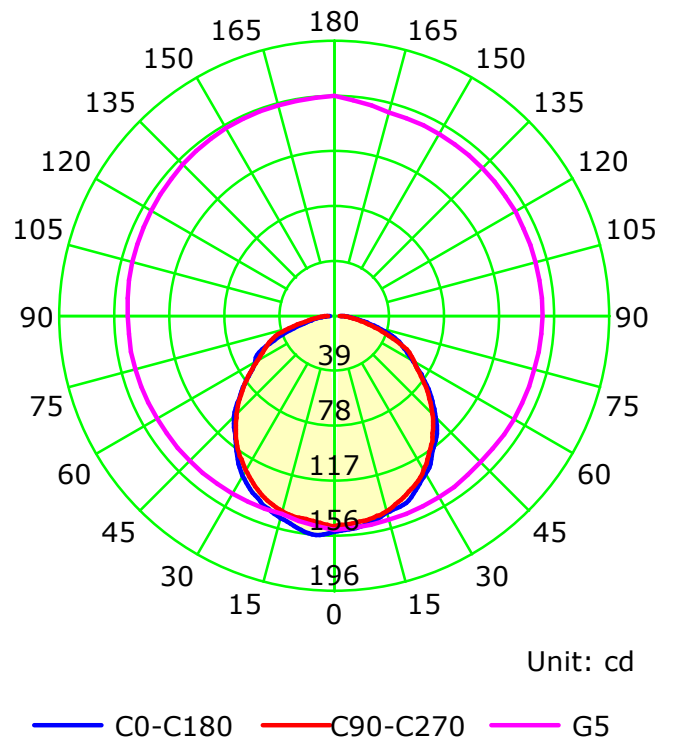

C Plane (°):0.0-360.0: 15.0
 Test Lab:
 Test Type: TYPE C
 Temperature:
 Operator:

Gamma Plane (°):0.0-90.0:1.0
 Test Device: GPM-1800B
 Distance: 3.150 m
 Humidity:
 Inspector:

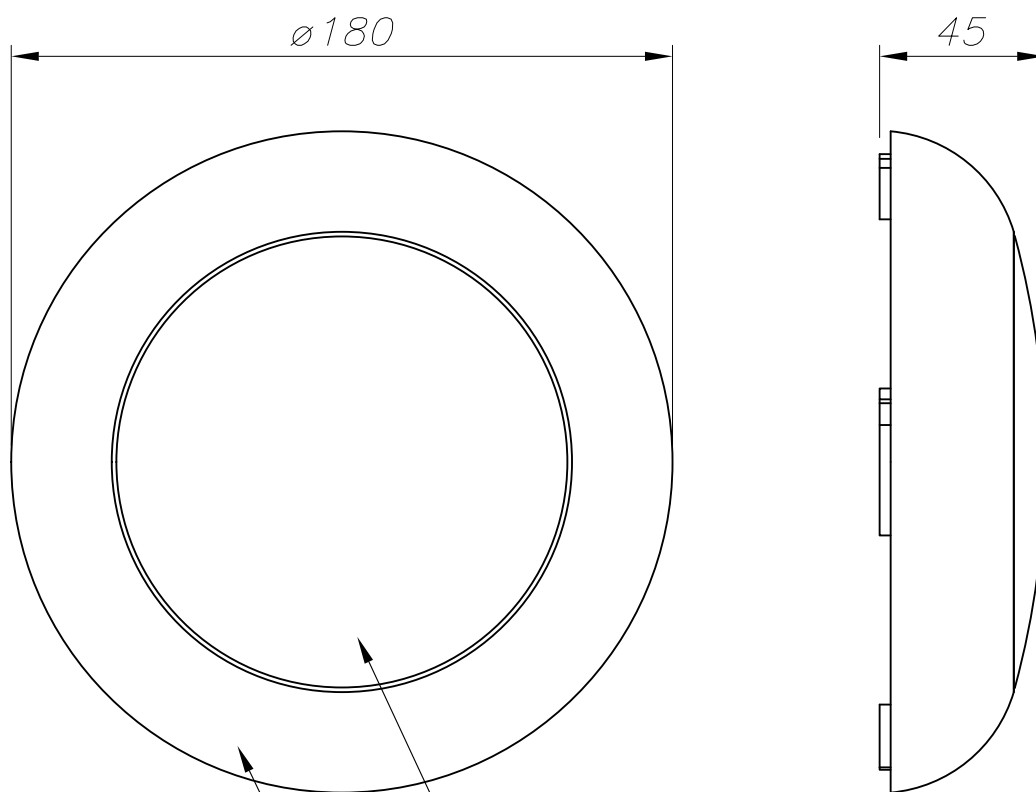

POLICARBONATO TRANSPARENTE MATE
TRANSPARENT MATT POLYCARBONATE

POLICARBONATO BLANCO
WHITE POLYCARBONATE

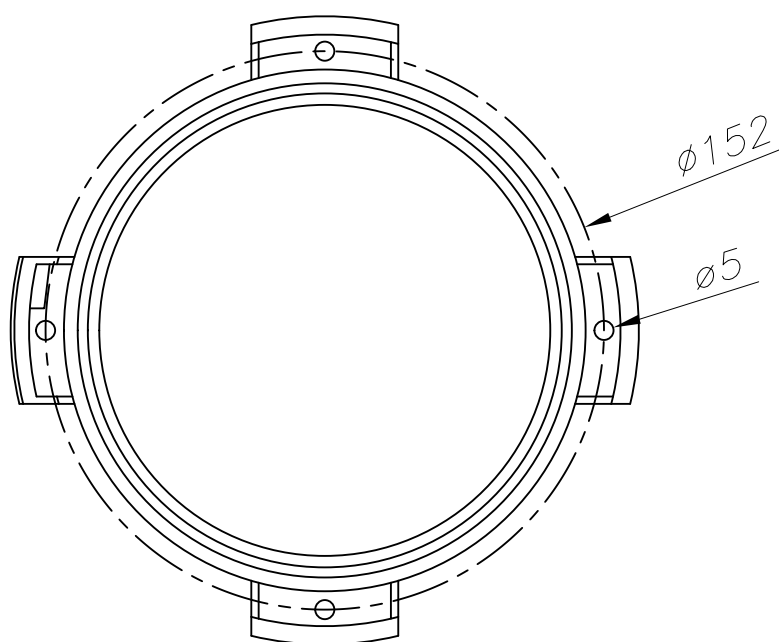

PLANTILLA DE INSTALACIÓN
INSTALLATION TEMPLATE

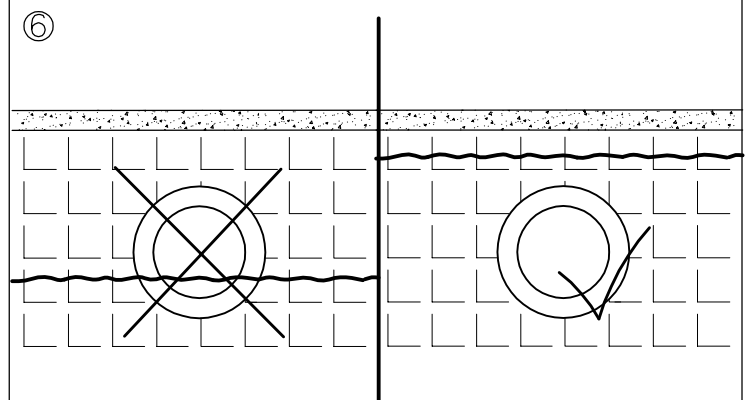
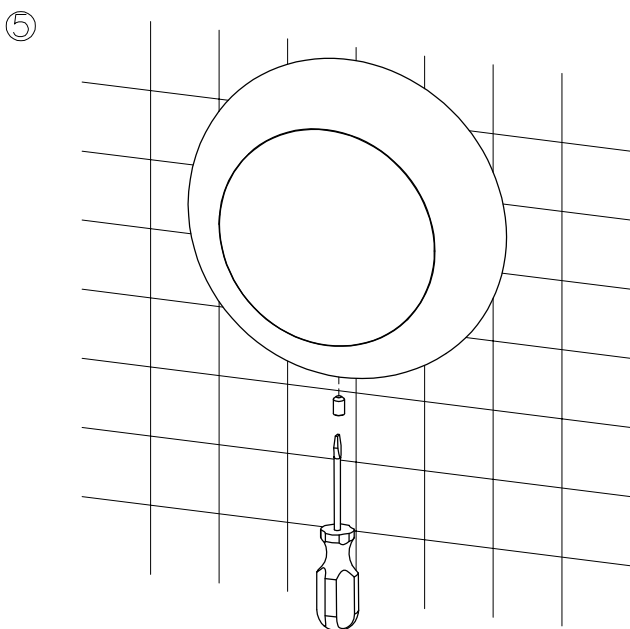
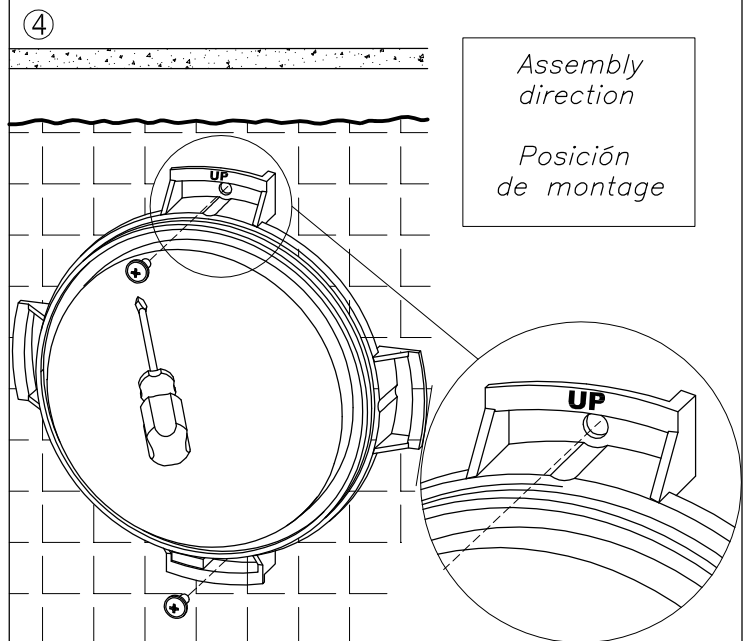
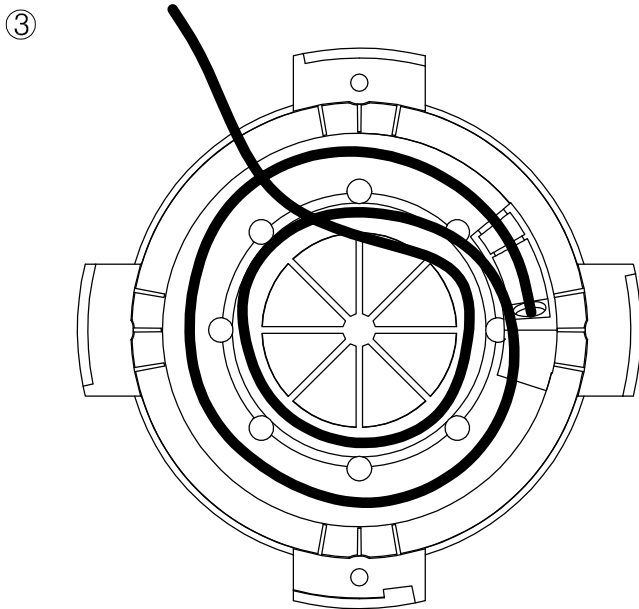
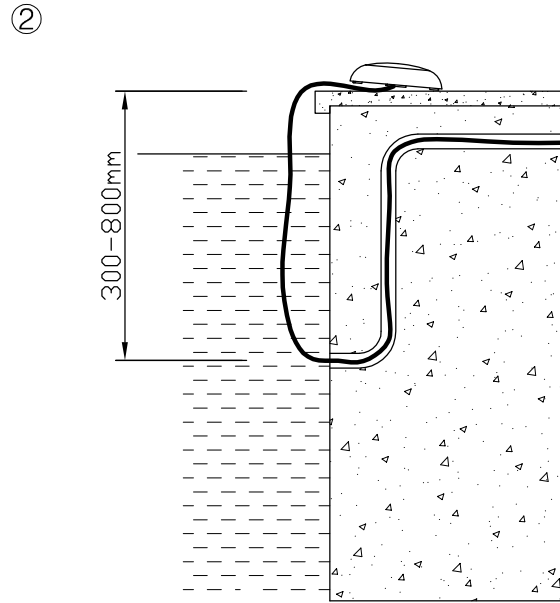
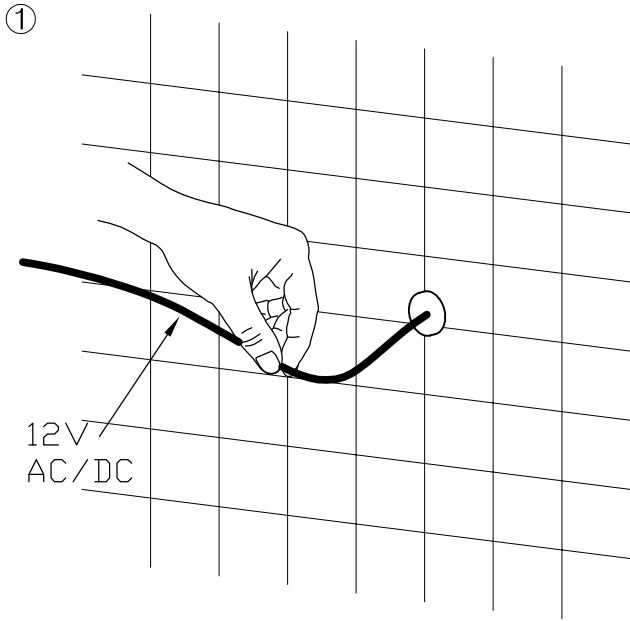

- Para usar únicamente sumergida en agua
- Only use under water
- Utiliser uniquement plongée dans l'eau
- Nur unter Wasser eingetaucht benutzen
- Uso esclusivo sotto l'acqua
- Usar apenas submerso em água
- Только для использования в воде